

# Electrolux HD-Line

## Digital refrigerators 1400 lt

The Electrolux HD-Line offers one of the most comprehensive choices of refrigerated storage cabinets available. Constructed internally and externally in stainless steel, operating over refrigeration or freezer temperature ranges, with solid or glass doors, and in a choice of either 650 or 1400 liter capacity. The refrigerator models detailed on this sheet have a capacity of 1400 liters.



728420



728423

### EASY TO INSTALL

- Mounted on adjustable stainless steel feet, with castors as an option.
- Choice of doors to suit varying kitchen requirements.
- Refrigerator models have operating temperatures that can be adjusted from  $-2\text{ }^{\circ}\text{C}$  to  $+10\text{ }^{\circ}\text{C}$  to suit both meat and dairy storage requirements.
- Suitable for ambient temperatures of up to  $+43\text{ }^{\circ}\text{C}$  in case of full door or up to  $+32\text{ }^{\circ}\text{C}$  in case of glass door models.

### EASY TO CLEAN

- Forced air circulation for rapid cool down and even temperature uniformity.
- Constructed from the highest quality AISI 304 stainless steel with radiused corners to the interior base, which is pressed from a single sheet.
- Evaporator unit is inset into the top of the refrigerated chamber to provide an obstruction free interior.
- Refrigerators are fitted with defrost outlet pipe.

### EASY TO USE

- Accommodates GN 2/1 containers or shelves on anti-tilt runners.
- External digital temperature display.
- Interior light and lockable door.
- Refrigerator with automatic defrost.



**Electrolux**

**Electrolux HD-Line  
Digital refrigerators 1400 lt**

**EASY TO MAINTAIN**

- Heavy-duty construction that avoids use of any plastic parts.
- Single refrigeration unit (compressor, condenser and evaporator) that can be removed in a single piece from either the top or back.
- Evaporator cover is easily removable for maintenance.
- IPX5 Certified.

**EASY ON THE ENVIRONMENT**

- 20% reduction in energy consumption compared to previous models.
- Cabinet fitted with up to 75 mm thickness of cyclopentane insulation for best insulating performance with 100% environmental protection.

- Refrigerant type: R134a.
- CFC and HCFC free.
- All models comply with the standards required by the main international approval bodies and are CE marked.

|                                    | <b>RH14RD2F<br/>728420</b> | <b>RH14RD2FR<br/>728422</b> | <b>RH14RD4F<br/>728423</b> | <b>RH14RD2G<br/>728424</b> | <b>RH14RD2F6<br/>728444</b> |
|------------------------------------|----------------------------|-----------------------------|----------------------------|----------------------------|-----------------------------|
| <b>TECHNICAL DATA</b>              |                            |                             |                            |                            |                             |
| Operating temperature - min/max °C | -2/10                      | -2/10                       | -2/10                      | 0/10                       | -2/10                       |
| Operating mode                     | Ventilated                 | Ventilated                  | Ventilated                 | Ventilated                 | Ventilated                  |
| External material                  |                            |                             |                            |                            |                             |
| panels                             | 304 AISI                   | 304 AISI                    | 304 AISI                   | 304 AISI                   | 304 AISI                    |
| Gross capacity (D.I.N. 8952) - l.  | 1400                       | 1400                        | 1400                       | 1400                       | 1400                        |
| Cooling unit                       | Built-In                   | Remote                      | Built-In                   | Built-In                   | Built-In                    |
| Control type                       | Digital                    | Digital                     | Digital                    | Digital                    | Digital                     |
| External dimensions - mm           |                            |                             |                            |                            |                             |
| width                              | 1500                       | 1500                        | 1500                       | 1500                       | 1500                        |
| depth/with open doors              | 795, 1463                  | 795, 1463                   | 795, 1463                  | 795, 1474                  | 795, 1463                   |
| height                             | 2050                       | 2050                        | 2050                       | 2050                       | 2050                        |
| Min/Max internal humidity - %      | 75/90                      | 75/90                       | 75/90                      | 65/85                      | 75/90                       |
| N° and type of door                | 2                          | 2                           | 4x1/2                      | 2                          | 2                           |
| Door hinges                        | 1 Left+1 Right             | 1 Left+1 Right              | 2 Left+2 Right             | 1 Left+1 Right             | 1 Left+1 Right              |
| N° and type of grids (included)    | 8, GN 2/1                  | 8, GN 2/1                   | 8, GN 2/1                  | 8, GN 2/1                  | 8, GN 2/1                   |
| Compressor power - HP              | 3/8                        |                             | 3/8                        | 3/8                        |                             |
| N° defrost in 24 hrs.              | 4/28'                      | 4/28'                       | 4/28'                      | 4/28'                      | 4/28'                       |
| Refrigerant type                   | R134a                      | R134a                       | R134a                      | R134a                      | R134a                       |
| Refrigerant quantity - g.          | 360                        |                             | 360                        | 380                        | 360                         |
| Refrigeration power - W            | 512                        |                             | 512                        | 640                        |                             |
| Refrigerant power                  |                            |                             |                            |                            |                             |
| at evaporation temperature - °C    | -10                        | -10                         | -10                        | -10                        | -10                         |
| Power - kW                         |                            |                             |                            |                            |                             |
| installed-electric                 | 0.513                      | 0.7                         | 0.513                      | 0.538                      | 0.52                        |
| Net weight - kg.                   | 248                        | 223                         | 252                        | 266                        | 252                         |

**Electrolux HD-Line  
Digital refrigerators 1400 lt**

|  | <b>RH14RD2F<br/>728420</b> | <b>RH14RD2FR<br/>728422</b> | <b>RH14RD4F<br/>728423</b> | <b>RH14RD2G<br/>728424</b> | <b>RH14RD2F6<br/>728444</b> |
|--|----------------------------|-----------------------------|----------------------------|----------------------------|-----------------------------|
| <b>INCLUDED ACCESSORIES</b>              |                            |                             |                            |                            |                             |
| 2 S/S RUNNERS FOR 600-650/1300-1400L.REF | 8                          | 8                           | 8                          | 8                          | 8                           |
| 2/1 GN GREY "RILSAN" GRID                | 8                          | 8                           | 8                          | 8                          | 8                           |
| <b>ACCESSORIES</b>                       |                            |                             |                            |                            |                             |
| 1/1 GN RILSAN STEEL WIRE BASKET H=150 MM | 881043                     | 881043                      | 881043                     | 881043                     | 881043                      |
| 2 S/S RUNNERS FOR 600-650/1300-1400L.REF | 881456                     | 881456                      | 881456                     | 881456                     | 881456                      |
| 2/1 GN AISI 304 S/S GRID                 | 881067                     | 881067                      | 881067                     | 881067                     | 881067                      |
| 2/1 GN CHROME BASKET+2 RUNNERS H200      | 881468                     | 881468                      | 881468                     | 881468                     | 881468                      |
| 2/1 GN GREY "RILSAN" GRID                | 880720                     | 880720                      | 880720                     | 880720                     | 880720                      |
| 2/1 GN GREY RILSAN GRID W/ 2 RUNNERS     | 881454                     | 881454                      | 881454                     | 881454                     | 881454                      |
| 2/1 GN PVC CONTAINER W/LID AND 2 RUNNERS | 881462                     | 881462                      | 881462                     | 881462                     | 881462                      |
| 3 GREY RILSAN CENTRAL GRIDS FOR 1400 L   | 881452                     | 881452                      | 881452                     |                            | 881452                      |
| 304 AISI S/S GRID GN 2/1 WITH 2 RUNNERS  |                            |                             |                            | 880185                     |                             |
| 4 SWIVELLING WHEELS (2 W/ BRAKE)         | 880178                     | 880178                      | 880178                     | 880178                     | 880178                      |
| ENERGY FREE ALARM DEVICE                 | 881089                     | 881089                      | 881089                     | 881089                     | 881089                      |
| GN 1/1 PLASTIC CONTAINER+FALSE BOTTOM    | 880705                     | 880705                      | 880705                     | 880705                     | 880705                      |
| GN 2/1 WIRE BASKET-H-150 MM+SIDE RUNNERS | 881467                     | 881467                      | 881467                     | 881467                     | 881467                      |
| KIT 11 PASTRY TRAYS(400X600)-HD&SB REFR  | 880193                     | 880193                      |                            | 880193                     | 880193                      |
| KIT HACCP EKIS                           | 922166                     | 922166                      | 922166                     | 922166                     |                             |
| KIT INTEGRATED HACCP-DIG. REFR. (IR33)   |                            | 880205                      | 880205                     | 880205                     | 880205                      |
| KIT PLINTH TO INSTALL HD REF. 1200/1400  | 880207                     | 880207                      | 880207                     | 880207                     | 880207                      |
| KIT S/S PLINTH FOR 1400L HD REF/FREEZERS | 880043                     | 880043                      | 880043                     | 880043                     | 880043                      |
| MEAT RAIL FOR 650-1400 L REFRIGERATORS   | 881451                     | 881451                      | 881451                     | 881451                     | 881451                      |
| PEDAL OPENING FOR 1200/1400 L REFRIGER.  | 881459                     | 881459                      |                            | 881459                     |                             |
| PERFORATED SHELF GN 2/1                  | 881042                     | 881042                      | 881042                     | 881042                     | 881042                      |
| PRINTER FOR HACCP BASIC VERSION REFRIG.  | 881457                     | 881457                      | 881457                     | 881457                     | 881457                      |
| SET OF 8-1/1 GN PVC CONTAINERS FOR FISH  |                            | 881461                      | 881461                     | 881461                     | 881461                      |

HAB040

2010-05-28

Subject to change without notice

**Electrolux HD-Line  
Digital refrigerators 1400 lt**

728420, 728423, 728422

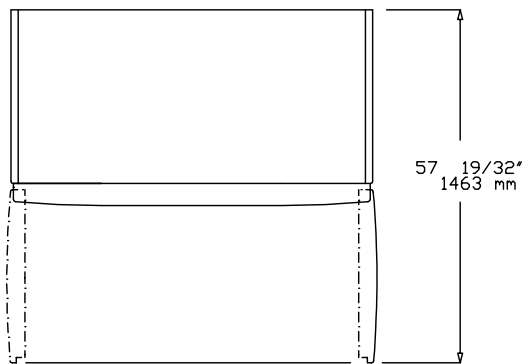
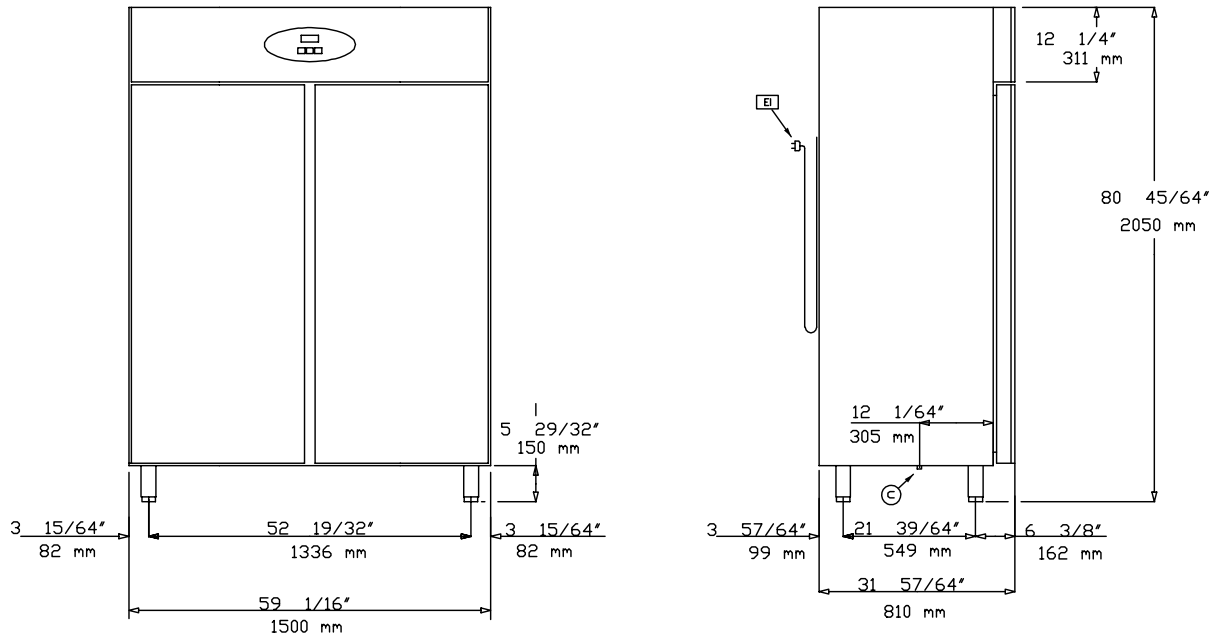

589729000

HAB040

2010-05-28

| LEGEND                               | RH14RD2F<br>728420 | RH14RD2FR<br>728422 | RH14RD4F<br>728423 |
|--------------------------------------|--------------------|---------------------|--------------------|
|                                      | D - Water drain    | 1/2"                | 1/2"               |
| ED - Remote electrical connection    |                    | ●                   |                    |
| EI - Electrical connection           | 230 V, 1N, 50      | 230 V, 1N, 50       | 230 V, 1N, 50      |
| RI - Remote refrigeration connection |                    | ●                   |                    |

Subject to change without notice

Electrolux HD-Line  
Digital refrigerators 1400 lt

728424

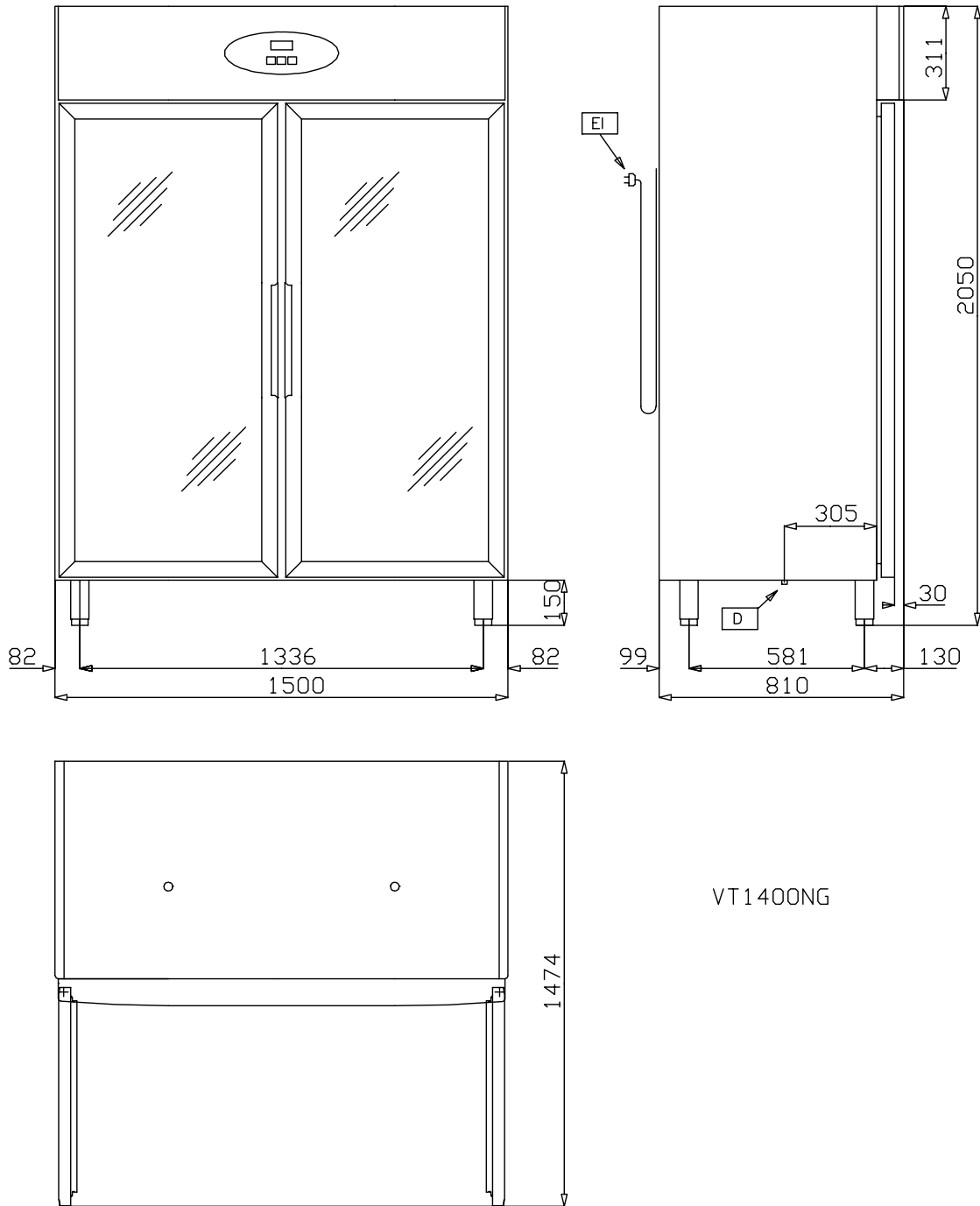

VT1400NG

|  |                                  |
|--|----------------------------------|
| <b>LEGEND</b><br>D - Water drain<br>EI - Electrical connection | <b>RH14RD2G</b><br><b>728424</b> |
|  | 1/2"                             |
|  | 230 V, 1N, 50                    |

HAB040

2010-05-28

Subject to change without notice

Electrolux HD-Line  
Digital refrigerators 1400 lt

728444

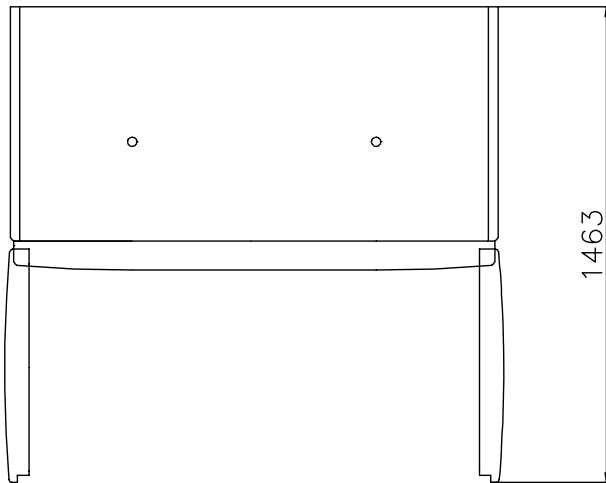
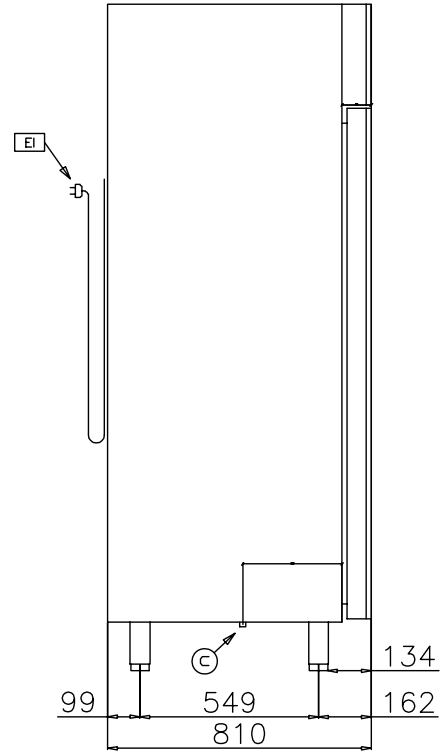
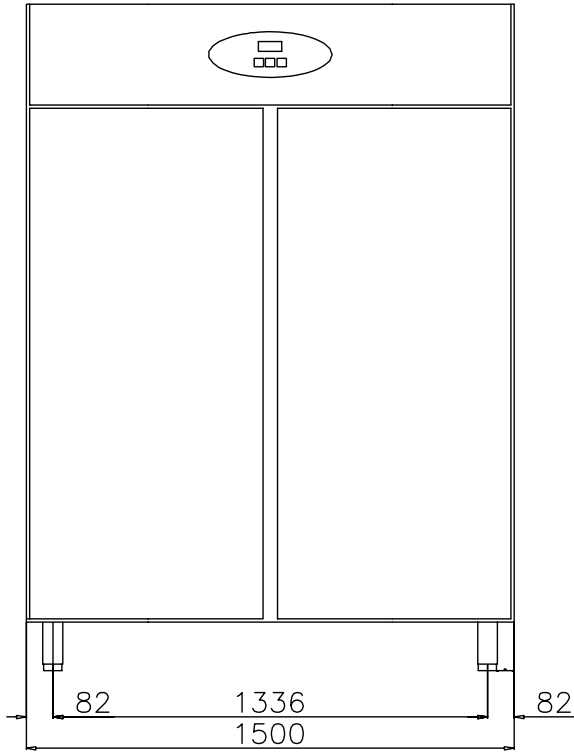

VT1400NF

HAB040

2010-05-28

Subject to change without notice

|  |                                   |
|--|-----------------------------------|
| <b>LEGEND</b><br>D - Water drain<br>EI - Electrical connection | <b>RH14RD2F6</b><br><b>728444</b> |
|  | 1/2"                              |
|  | 220 V, 1N, 60                     |